

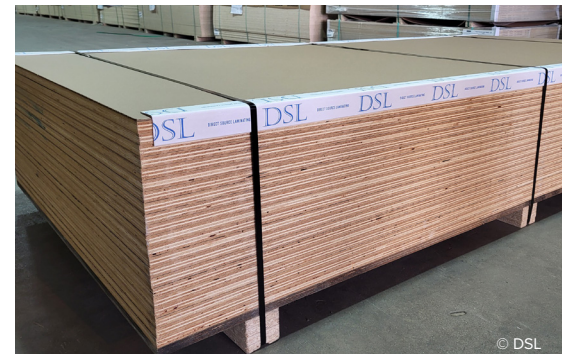

## COMMONWEALTH PLYWOOD DISTRIBUTION

Catalogue - 2nd edition

# 2022



View and order our full line of products on our website.

**[commonwealthplywood.com](http://commonwealthplywood.com)**

London : 519.681.5304  
Rexdale : 416.675.3266  
Waterloo : 519.885.2810

Ottawa : 613.688.2280  
North Bay : 705.495.3166



All the products you need  
for each and every project.



**COMMONWEALTH PLYWOOD  
DISTRIBUTION**

**Everything you need is just  
one click away!**



**Order Online now:**

Access all your products anytime.  
When it's convenient for YOU.



[commonwealthplywood.com](http://commonwealthplywood.com)

## Create your account

» Go to [commonwealthplywood.com](http://commonwealthplywood.com)

» Click on «Create an account»

» Registration form

It's that easy! You will need to have your Commonwealth Plywood Customer number. You can find your six (6) digits number in the upper left corner of any invoice. Follow the steps to register and wait for the approbation.

## ADVANTAGES



### Inventory checks:

No need to call an agent, just click on the product to view if it's available at your branch.



### Easy quotes & access to your personalized pricing:

You have access to your prices whenever you want which makes it that much easier to provide quotes to your clients.



### Favourites:

Keep your favourite items handy. You can also organize them by folders.



### Orders and product history:

Easy to navigate through old orders and your recent purchased products history.



# garnica

Challenge the ordinary



## Ultralight and High Insulation Sandwich Panels

Lightness that challenges the impossible

- Ultralight and exceptional thermal insulation
- Perfect dimensional stability matched by an excellent result in elasticity and rupture modules

**ultralight**

### Applications/Uses:

Specifically designed for applications seeking to lighten weight load, such as RVs, boats, furniture and decoration, or where thermal insulation is especially important, such as doors, roofs or panelling.



FORMATS		
Product code	Thickness	Thickness
560812	3/4"	4' x 8'
560811	3/4"	5' x 10'

TECHNICAL FEATURES					MOE (N/mm <sup>2</sup> )		MOR (N/mm <sup>2</sup> )		Thermal performance	
Thickness (")	Weight (Lb/ft <sup>2</sup> )	Density* (Lb/ft <sup>3</sup> )	Face Screw Holding (kgf)	Moisture content (%)	Long.	Perp.	Long.	Perp.	Thermal resistance "R" (m <sup>2</sup> ·K/W)	Thermal transmit. "u" (W/m <sup>2</sup> ·K)
3/4	0,9176	15,5	54	8-12	1900	2 500	17	14	0.496	2.01



Certifications on demand:  
**CARB Phase 2 / TSCA Title VI**



## THE BEST SOURCE FOR YOUR PANEL LAMINATION NEEDS

Our process is all about quality and efficiency. Utilising our state of the art automated panel laminating will allow your operators to spend more time manufacturing parts and completing jobs.

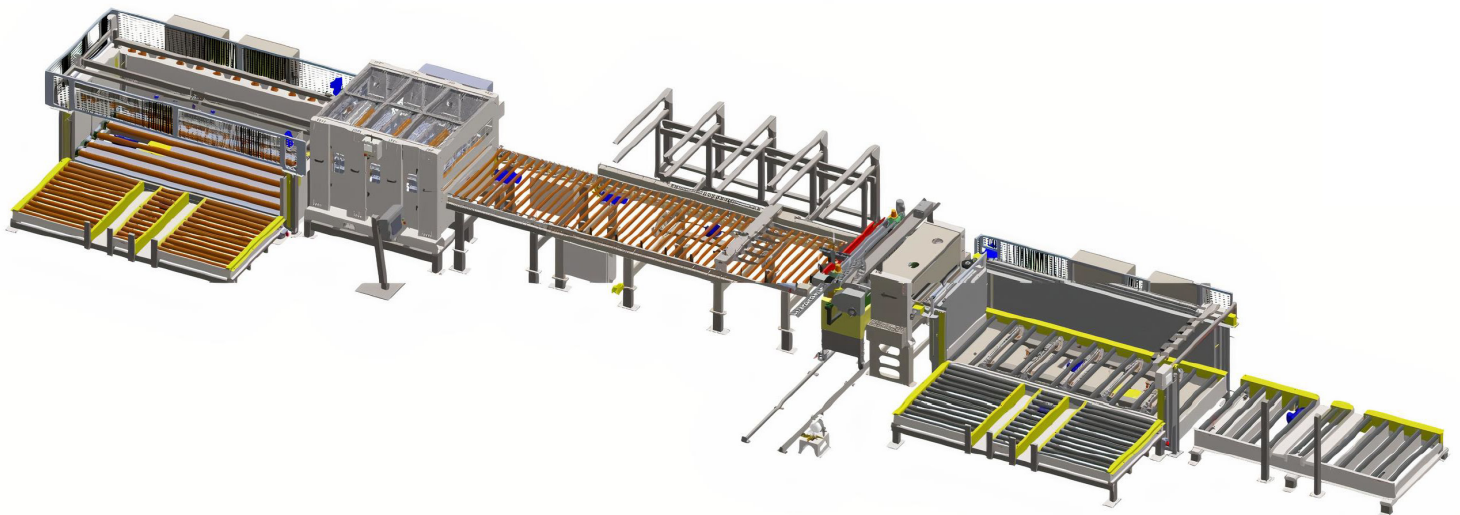

We provide panels from 4' x 8' to 5' x 12' on all types of cores from 3/8 thickness and up.







**Please call your Commonwealth Plywood sale representative for more details on our panel laminating offer!**





## Target Collection

The new Target Collection from Formica offers you a match to bestselling colours to complete your projects.

	Formica Colour Code	Colour name	«Target»
	3245 - 58	Smoke	123
	8861 - 58	Traditional Maple	290
	8862 - 58	Lively Walnut	G21
	8863 - 58	Natural Cerise	744
	8864 - 58	Brown Cerise	745
	8865 - 58	Charcoal Cerise	241
	8866 - 58	Silver Alloy	961
	8867 - 58	Blurred Frost	H56
	8868 - 58	Blurred Slate	H57
	8869 - 58	Blurred Ebony	H58
	9642 - WR	Oxidized Wood	K06
	9643 - WR	Cinder Wood	K04

You get the quality of the Formica laminate and a match to your decorative panel!



## Living Impressions 2022 Collection

New 2022 Collection with new on trend decor and finishes!

		Formica Colour Code	Colour name
180 fx		3700	White Alabaster
		3701	Manhattan Marble
		3702	Mediterranean Marble
		3703	Woodland Marble
		3704	Marbled Gray
Premium fx		3720	White Pearl Cascade
		3706	Patine Concrete
		3707	Patine Bronze
		3712	Walnut Butcherblock
		3711	Slate Noir
Modern Essentials		3705	Sugar Glass
		3710	Smoke Onyx
		3708	Burnished Coin
		3709	Burnished Iron



Most decors available in 4' x 8' and 5' x 12', ask your sales representative to confirm!



**The Original**  
**ROBERTSON®**

Celebrating more than a Century of Quality and Innovation  
Plus de 100 ans D'Innovation et de Qualité



## ABOUT Robertson:

Since our inception in 1908, our company has been committed to maintaining the highest level of excellence in our products and services for valued customers. We supply multi-purpose screws for every application, from decking, cabinetry, vinyl window & doors, sheet metal, framing and wood applications.

Today, Robertson Inc. is the leading manufacturer and global supplier of high-quality screws and specialty fasteners. Our research and development experts continue to design and innovative quality product to outperform in any condition.

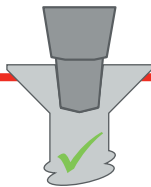

### Robertson® “Cling Fit”

Robertson® Bits and Screws provide maximum recess penetration and “Cling Fit”.

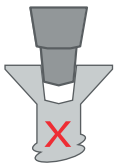

Recess Too  
Narrow



Recess Too  
Large

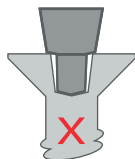

Incorrect  
Recess Angle

**Have any questions about the  
Robertson products?**

**Call your sales representative,  
we can definitely help guide you.**





# SHOP ONLINE 24/7



[commonwealthplywood.com](http://commonwealthplywood.com)



**COMMONWEALTH PLYWOOD  
DISTRIBUTION**

## Toronto

25, Dansk Court  
Rexdale, ON M9W 5N6  
416.675.3266  
1.800.268.6965

## London

1010, Green Valley Road  
London, ON N6N 1E3  
519.681.5304  
1.800.265.6003

## Waterloo

100, Randall Drive  
Waterloo, ON N2J 4A9  
519.885.2810  
1.800.563.6081

## North Bay

12, Old Sturgeon  
Falls Road  
North Bay, ON P1B 8G5  
705.495.3166  
1.800.461.3211

## Ottawa

2950, Swansea  
Crescent  
Ottawa, ON K1G 3W4  
613 688.2280  
1.877.536.2280

## OUR PARTNERS



we create.  
we innovate.

